

# ASTRID

## 3023DG

### MEDIUM OPEN FRAME

Sleek and chic, Astrid is designed as an airy geometric beauty balanced with robust welded construction. The inner light cluster, uniquely wired from the bottom, appears to float inside the outer cage. The two-tone finish further enhances the layering effect for added depth and dimension.

DETAILS	
FINISH:	Deluxe Gold
MATERIAL:	Steel
SLOPE DEGREE:	90
DIMMABLE:	YES - WITH DIMMABLE LAMP (NOT INCLUDED)

DIMENSIONS	
WIDTH:	20"
HEIGHT:	26.8"
WEIGHT:	5lb

LIGHT SOURCE	
LIGHT SOURCE:	Socketed
WATTAGE:	3-5w Cand. LED, 60w Equiv.
VOLTAGE:	120v

MOUNTING	
CANOPY:	5" Dia.
LEAD WIRE:	1 X 144"

SHIPPING	
CARTON LENGTH:	24
CARTON WIDTH:	25
CARTON HEIGHT:	25
CARTON WEIGHT:	18

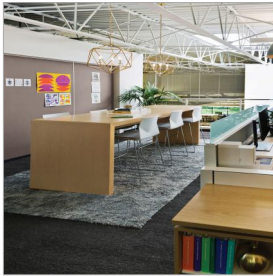

#### PRODUCT DETAILS:

- Suitable for use in dry (indoor) locations as defined by NEC and CEC. Meets United States UL Underwriters Laboratories & CSA Canadian Standards Association Product Safety Standards.
- This item may be hung on a sloped ceiling
- Luxurious gold finish with opulent sheen
- Merging the best of traditional and modern elements with a sophisticated and streamlined look
- Ideal for vintage filament bulbs (not included)

# HINKLEY

HINKLEY  
33000 Pin Oak Parkway  
Avon Lake, OH 44012

PHONE: (440) 653-5500  
Toll Free: 1 (800) 446-5539

[hinkley.com](http://hinkley.com)